

*Steelock™ a unique steel top hat batten mounting system.  
Thermoseal™ a unique thermally efficient closed cavity cladding system.*

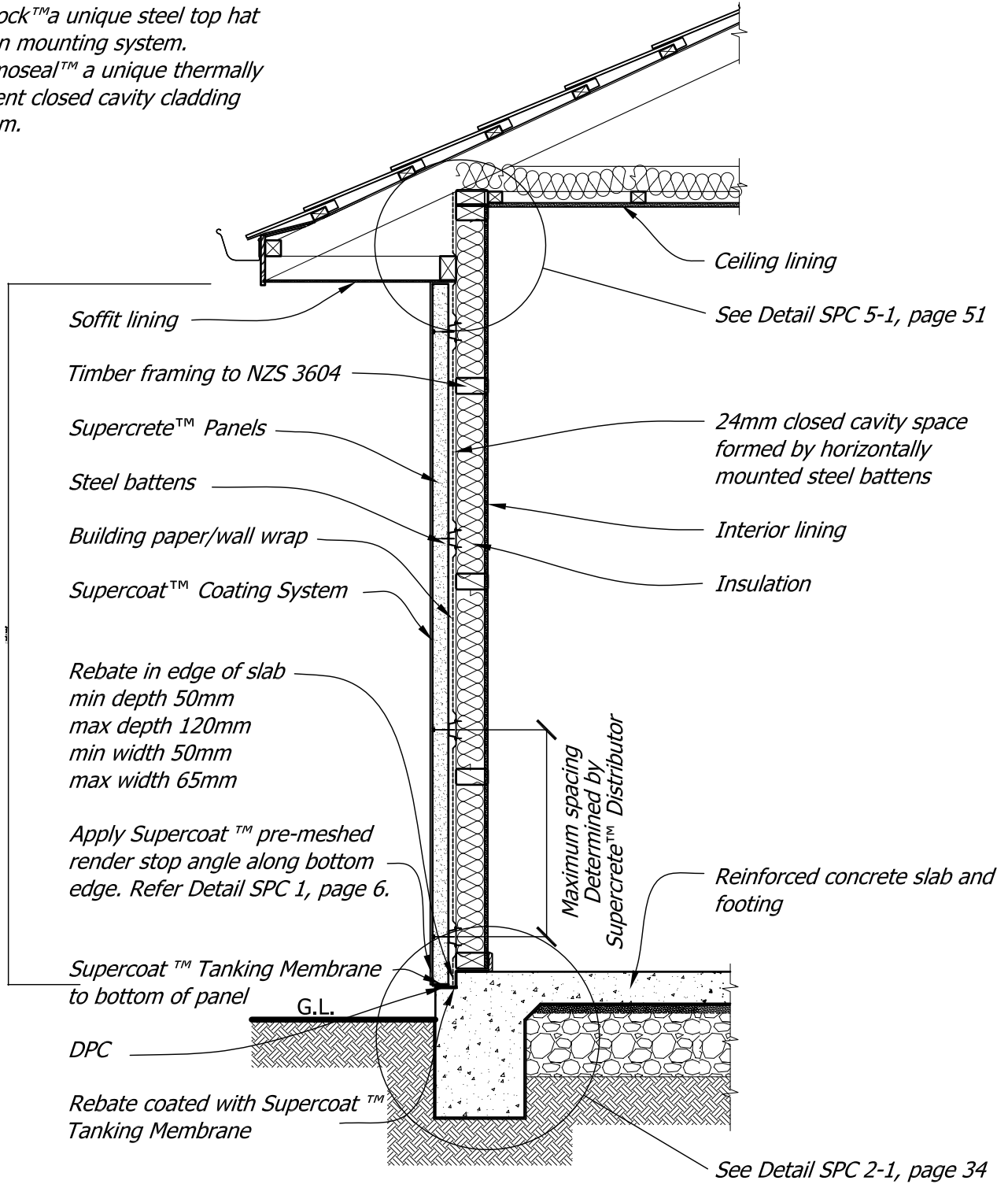

**NOTE:**

1. The Supercrete™ Distributor determines the number of battens and batten spacing using wind and earthquake load information supplied by the building owner.
2. Where the wall exceeds maximum panel length panels will be butt jointed, using a staggered joint arrangement (refer Detail SPC 1-8), with additional battens for panel end supports or horizontally orientated panels may be incorporated to suit height dimensions.
3. The building owner must determine the design panel height (bottom of foundation rebate to soffit dimension) and note on the consent drawing documentation. Main contractor must notify the Supercrete™ Distributor of any changes in panel height as soon as possible

<b>Supercrete™</b>	Title: Section through Single Storey Wall		
	Date: February 2014	Scale: N.T.S.	Detail No. SPC 1-5
<b>PANEL CLADDING CONSTRUCTION</b>	This drawing must be read in conjunction with the Supercrete Panel Cladding System Design & Installation Guide		