

**NOTE:**

All gaps between wall and frame to be filled with Hilti CP 611A intumescent Firestop Mastic or equivalent

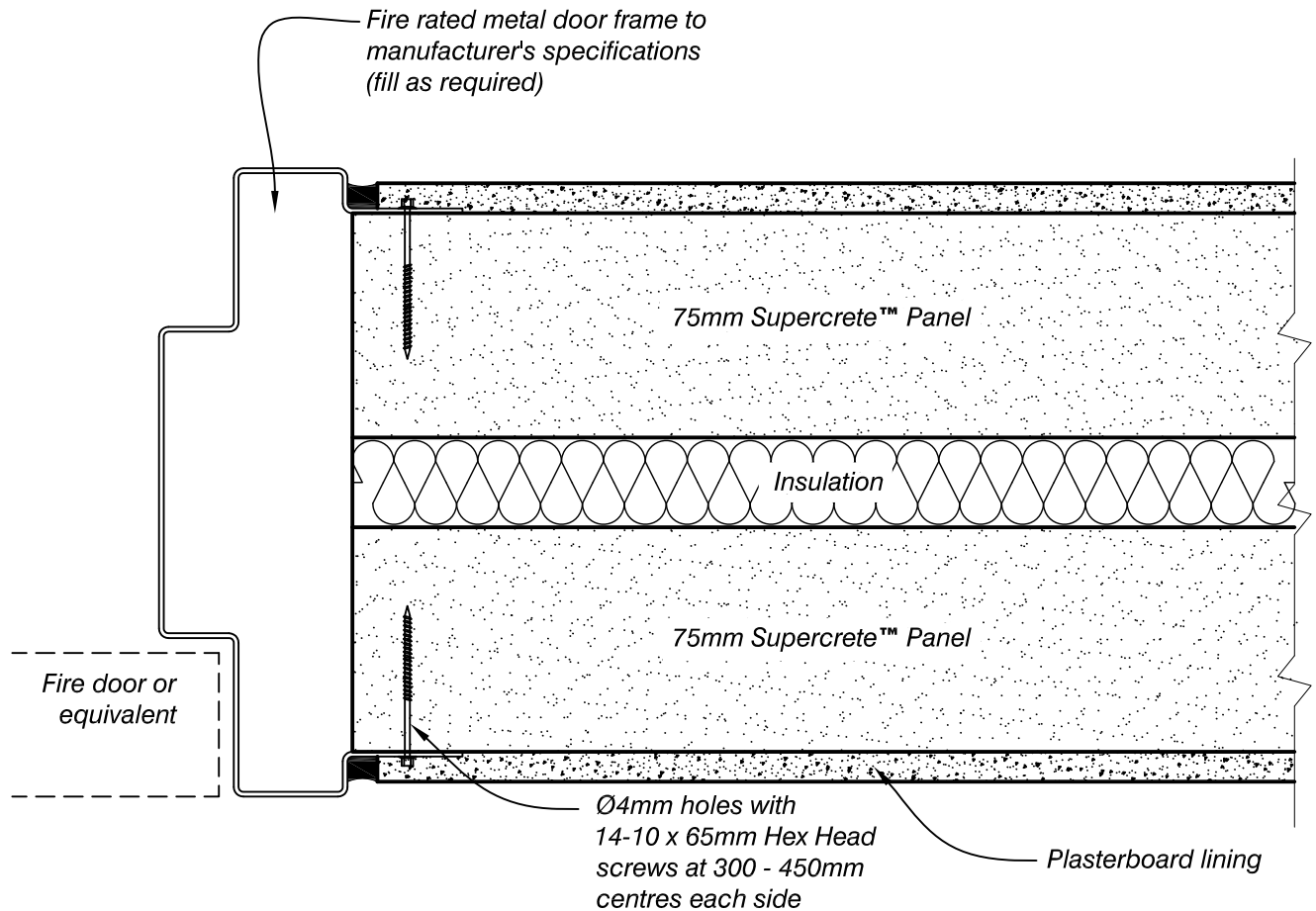

**IMPORTANT**

1. All door frame installations and detailing to be approved by door frame manufacturer
2. Continuously screw fix door frame to Supercrete™ Panel around perimeter of door opening
3. Supercrete™ recommends core filling of the door frame for additional robustness
4. Fix door fame at the base

**Supercrete™**

Title: A.W.S. - Typical Fire Door or similar  
for Type 4 Wall

Date: December 2013

Scale: N.T.S.

Detail No. 10.6.5

This drawing must be read in conjunction with the Supercrete Acoustic Wall Systems Design Guide